

UPSIDE DOWN

N^o 5

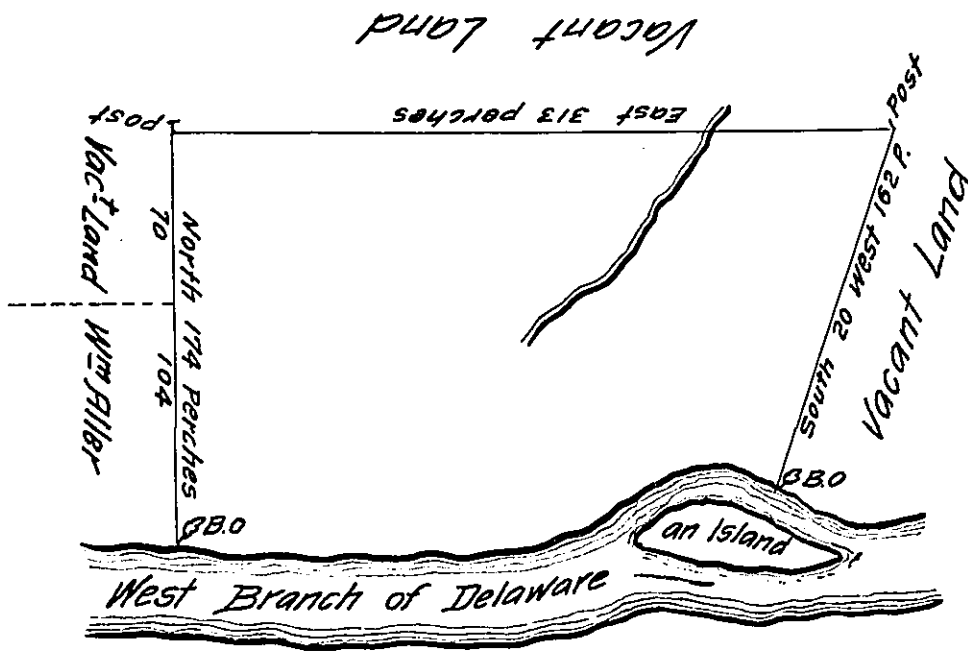

Surveyed on the 24 day of November 1736 to John Simson in right of William & Margaret Lowther the above described Tract of Land Situate on the West Branch of Delaware - in the County of Bucks Containing 274 acres with the usual allowance of Six P. Cent.

Nich^o Scull

In part of 5000^{as}

Warr^t dated the 31st of October 1733.

IN TESTIMONY that the above is a copy of the original remaining on file in the Department of Internal Affairs of Pennsylvania, made conformably to an Act of Assembly approved the 16th day of February, 1833, I have hereunto set my Hand and caused the Seal of said Department to be affixed at Harrisburg, this twelfth day of December 1910.

Nevoy Houck
Secretary of Internal Affairs.